

FREQUENTLY ASKED QUESTIONS

Non-Permit Holders

Q: Where are meters located and how long can you park at meter locations?

Different areas of the Village have different limitations on maximum allotted meter times. Pictured below are the different meter locations within the Village, and their associated meter limits, as indicated by the colored lines across each street.

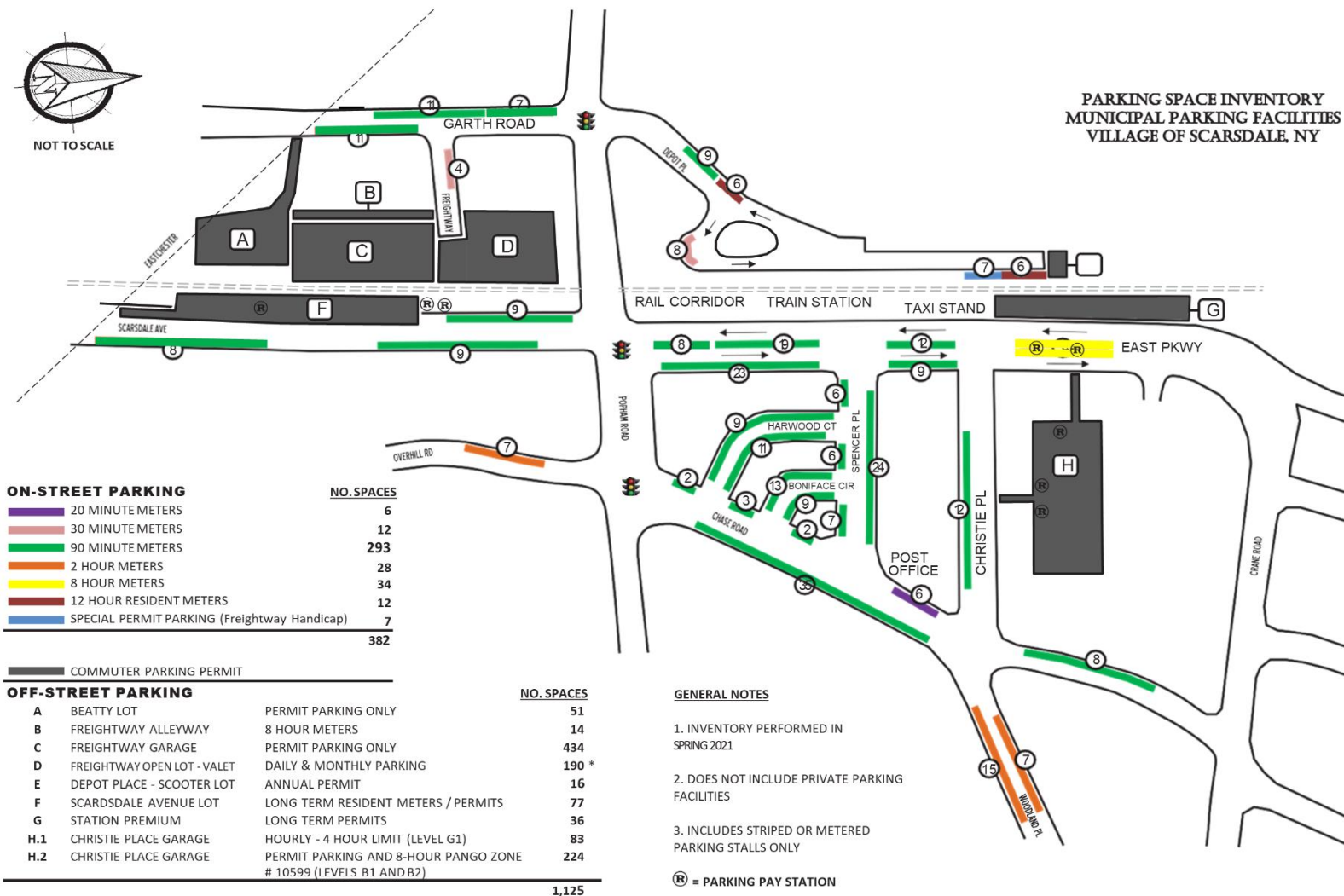

Q: What is the per hour cost for the meters at metered parking?

Meters cost \$1 per hour for the first four hours entered, and cost \$0.75 for every subsequent hour. This price remains static across all meters and regardless of ownership of a Parking Meter Permit.

Q: Can you park in the Christie Place Garage?

There are 4-hour parking meters available on the street level of the Christie Place Garage.

Q: What is valet parking and what are the rates?

The Valet lot is located directly next to the Freightway Garage and is privately operated by ProPark, a premier Parking Management Company. The Valet operates from 5AM - 9PM, Monday – Friday and offer both a monthly permit option and daily parking. Village of Scarsdale residents are provided preference for permits at this lot (if you're a Village resident and have difficulty obtaining a permit please contact the Village Manager's Office 722-1110). Non-Residents may be placed on a wait-list.

Maximum monthly permit prices are set as follows (tax not included):

- January 01, 2022 – December 31, 2022: \$160 regular / \$185 oversized vehicles
- January 01, 2023 – December 31, 2023: \$165 regular / \$190 oversized vehicles

Hourly Transient Parking:

- January 01, 2022 – December 31, 2022:
 - \$3.00 per hour regular vehicles / \$4.50 per hour oversized vehicles
 - (Not to exceed \$17.00 per day for regular vehicles or \$21.00 per day for oversized vehicles)
- January 01, 2023 – December 31, 2023:
 - \$3.00 per hour regular vehicles / \$4.50 per hour oversized vehicles
 - (Not to exceed \$18.00/day for regular vehicles or \$22.00 per day for oversized vehicles)

For further information or questions please contact directly ProPark at (914) 501-6015.

Q: Where can I find long term parking?

12-hour parking is available on Scarsdale Avenue and Depot Place meters starting at 8 AM for Meter Permit holders and 11 AM for non-permit holders, Monday through Saturday. Those with a Parking-Meter Permits may park in these spots starting at 8 AM.

Q: Who do I contact if I have questions, comments, concerns or issues?

Please contact the Village Clerk's Office via email at parking@scarsdale.com, or by calling 914.722.1175.

For updates visit www.scarsdale.com.